

Edge-lit LED Panel [EU]

Available Sizes

PL6060	595x595mm
PL30120	295x1195mm
PL60120	595x1195mm
PL6262	620x620mm



Features & Benefits

- 2 Sides Edge-lit, less heat dissipation, longer lifespan
- 100% PMMA LGP, never yellowing
- Flicker free
- Patent design to avoid blue light & water ripper & light spot
- UGR<19 available
- Dali, Triac, Push, 0-10V Dimmable

General Information

Model	PL-6060M	PL-30120M	PL-60120M	PL-6262M
Wattage(W)	26 30 36 40		40 50 72	26 30 36 40

Efficacy(lm/W)	100/120,130 for 26W
IP Rating	20
Warranty	5 Years (50000Hrs)
Dimming	Optional: Non-dim, DALI, Triac-dim, Push-dim, 0/1-10V Dim
Leds Type	4014
Environment	Indoor
Working Temperature	-25°C-40°C
Relative Humidity	10%-90%RH
Color Finish	RAL9016
Switching Cycles	>30,000 times

Construction

Frame Material	Aluminum
Light Guide Plate(LGP)	PMMA
Diffuser	PS
Back-plate Material	Galvanized Sheet

Suzhou Kinglight Optoelectronics Co.,Ltd

Performance Data

SDCM	<5
LIFESPAN (L80B20 @25°C)	≥50000Hrs
CRI	>80/>90
CCT	3000K/4000K/5000K/6000K
Beam Angle	110°
UGR	<22; <19 (4Hx8H, 8Hx4H)

Electrical

Input Voltage	AC:220-240V
Output Voltage	DC:28-40V
Power Factor	>0.9
THD	≤20%
Insulation Class	Class II
Safety Standards	EN 61347-1; EN 61347-2-13
EMC	EN 55015; EN 61000-3-2; EN 61000-3-3;EN 61547,etc.
Overload Protection	103~120%
Overload Protection Type	Auto Resume

Packaging

Gross Weight	3.2KG/PCS	3.7KG/PCS	6.7KG/PCS	3.5KG/PCS
Carton Size L*W*H(mm)	655x245x705mm 1PCS/BOX 5PCS/CTN	1255x245x405mm 1PCS/BOX 5PCS/CTN	1255x155x705mm 1PCS/BOX 3PCS/CTN	682x245x732mm 1PCS/BOX 5PCS/CTN
	655x200x705mm 2PCS/BOX 6PCS/CTN	1255x200x405mm 2PCS/BOX 6PCS/CTN	1255x140x705mm 2PCS/BOX 4PCS/CTN	682x200x732mm 2PCS/BOX 6PCS/CTN

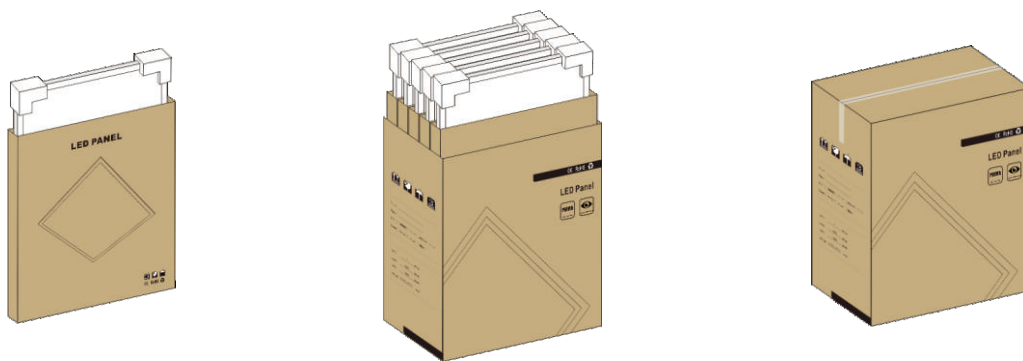

1pcs/inner box 5pcs/carton box

Certificates

TUV-GS, TUV-CE, TUV-CB, ERP, ROHS, ENEC, SAA, C-TICK



Suzhou Kinglight Optoelectronics Co.,Ltd

ADD:No.9 Southeast Avenue, Zhangjiagang Economic- Technical Development Area, Suzhou city, Jiangsu, China. (Southern area)

(86-755) 2908 1727

sales@jt-led.com

www.mgl-led.com

Panel connection diagram

Reversing connection may cause lighting delay.

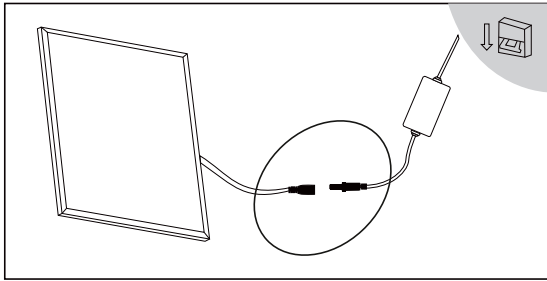

1.Connect driver to the panel

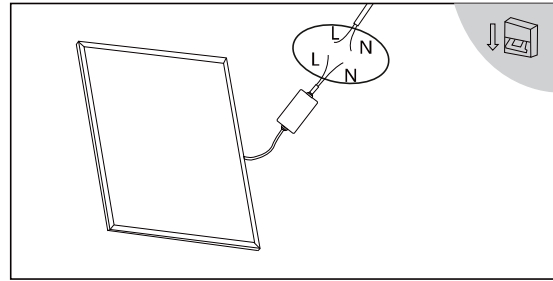

2.Then connect with city power(L-L;N-N)

Recession Installation

Customers can choose safety rope to avoid lamp falling caused by uncertain factors(earthquake,etc).

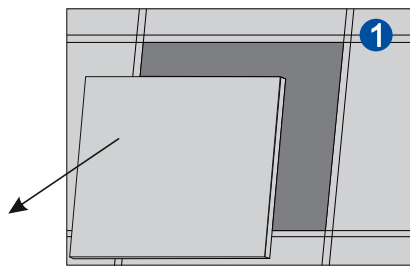

1.Remove the plasterboard from the ceiling.

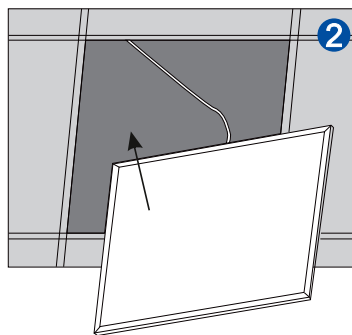

2.Fix the panel into ceiling.

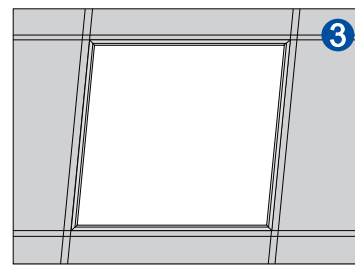

3.Installation finished.

Spring Installation MG-P01

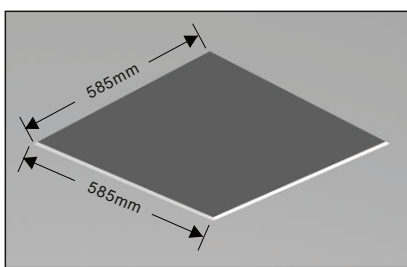

1.Open a hole on the ceiling with a size 585x585mm

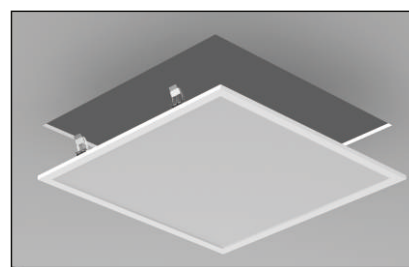

2.Pull up the springs

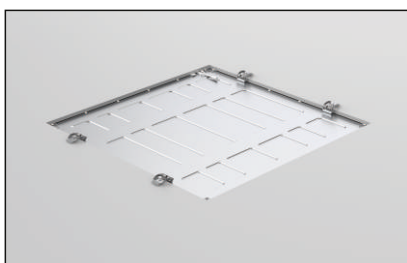

3.Install the panel to the hole

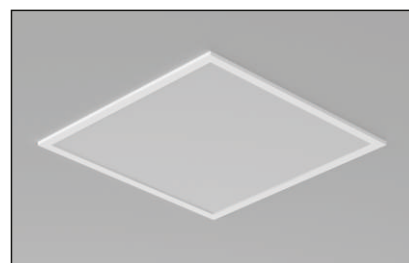

4.Fix the panel to the ceiling

Recessed Frame MG-M002

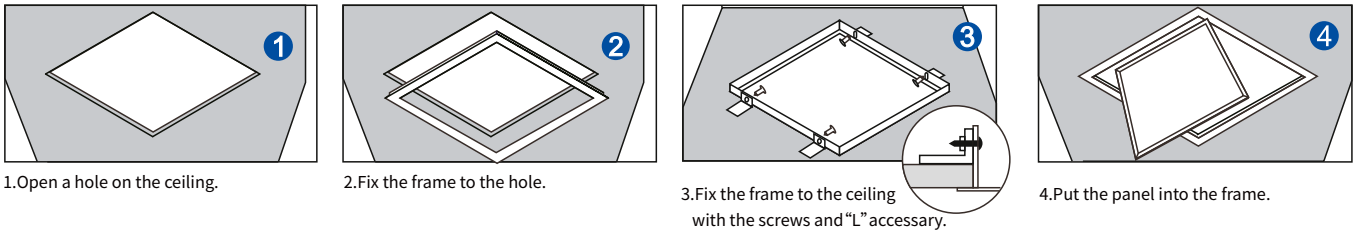

1. Open a hole on the ceiling.

2. Fix the frame to the hole.

3. Fix the frame to the ceiling with the screws and "L" accessory.

4. Put the panel into the frame.

Suspension Installation MG-D001

Panel 600x600

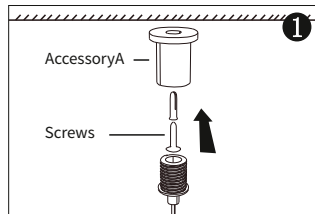

1. Screwing accessories A in ceiling

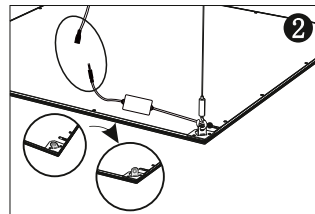

2. Upward hook on 4 corners, for suspending

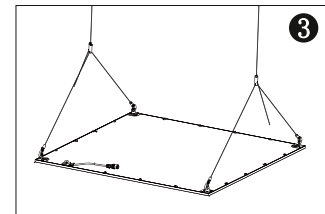

3. Finished installation

Panel 300x1200 600x1200

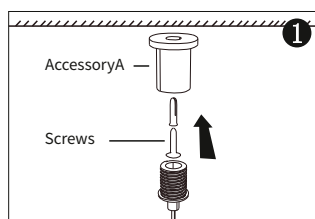

1. Screwing accessories A in ceiling

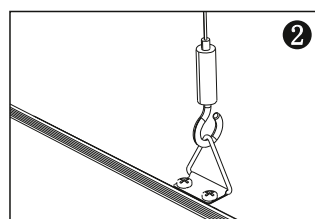

2. Triangle rings for hooks

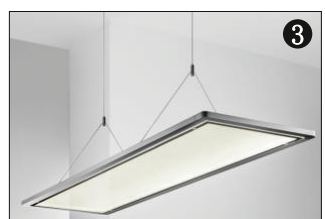

3. Finished installation

Surface Mounted Frame MG-M005

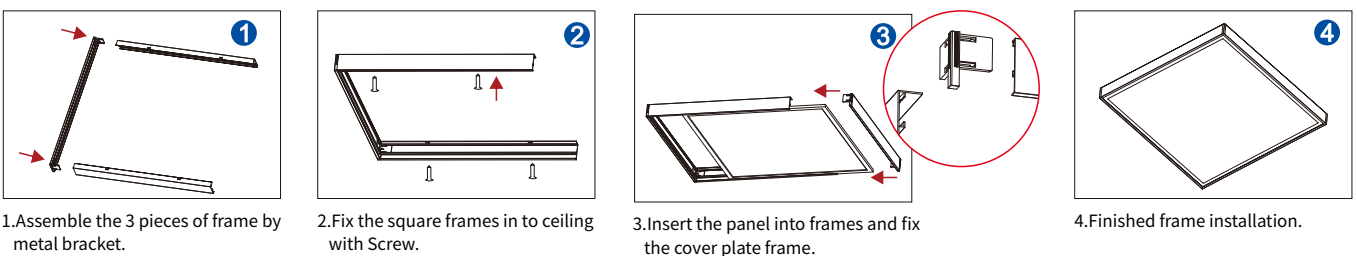

1. Assemble the 3 pieces of frame by metal bracket.

2. Fix the square frames in to ceiling with Screw.

3. Insert the panel into frames and fix the cover plate frame.

4. Finished frame installation.